



GUTEX Thermosafe-wd

TECHNISCHES DATENBLATT



GUTEX Thermosafe-wd ist die druckfeste Holzfaserdämmplatte für innenliegende Boden- und Wandaufbauten mit bis zu 5 kN/m² Nutzlast.

Anwendungsgebiete nach DIN 4108-10

- DEO-dm, WH

Inhaltsstoffe

- Unbehandeltes Tannen- und Fichtenholz
- 4,0 % PUR-Harz

Entsorgung

- Altholzkategorie: A2
- Abfallschlüsselnummern nach AVV
030105, 170201

Rohdichte ρ [kg/m ³]	~ 140
Nennwert Wärmeleitfähigkeit λ_D [W/mK]	0,040
Bemessungswert Wärmeleitfähigkeit λ_B [W/mK]	0,042
Dampfdiffusion μ	3
Druckspannung/-festigkeit [kPa]	≥ 70
Zusammendrückbarkeit bei Nutzlast ≤ 5 kPa [mm]	2
Strömungswiderstand [kPa s/m ²]	≥ 100
Spezifische Wärmekapazität [J/kgK]	2100
Maximale Einsatztemperatur [°C]	110
Brandverhalten Euroklasse nach DIN EN 13501-1	E
Produktnorm	DIN EN 13171
Plattenkennzeichnung	WF-EN 13171-T4-CP2- CS(10/Y)70-MU3-AF,100





GUTEX Thermosafe-wd

Detailinformationen

Kantenausbildung	Stumpf			
Dicke [mm]	20	30	40	60
Länge × Breite [mm × mm]	1250 × 600			
m ² /Stück	0,75			
Gewicht pro Platte [kg]	2,10	3,20	4,20	6,30
Gewicht pro m ² [kg]	2,80	4,20	5,60	8,40
Stück/Palette	224	140	112	70
Quadratmeter pro Palette [m ²]	168,00	105,00	84,00	52,50
Gewicht pro Palette [kg]	600	520	510	460
Nennwert Wärmedurchlasswiderstand R _D [m ² K/W]	0,50	0,75	1,00	1,50
Wärmedurchlasswiderstand R [m ² K/W]	0,45	0,70	0,95	1,40
sd-Wert [m]	0,06	0,09	0,12	0,18

Kantenausbildung	Stumpf		
Dicke [mm]	80	100	120
Länge × Breite [mm × mm]	1250 × 600		
m ² /Stück	0,75		
Gewicht pro Platte [kg]	8,40	10,50	12,60
Gewicht pro m ² [kg]	11,20	14,00	16,80
Stück/Palette	56	42	36
Quadratmeter pro Palette [m ²]	42,00	31,50	27,00
Gewicht pro Palette [kg]	490	470	
Nennwert Wärmedurchlasswiderstand R _D [m ² K/W]	2,00	2,50	3,00
Wärmedurchlasswiderstand R [m ² K/W]	1,90	2,35	2,85
sd-Wert [m]	0,24	0,30	0,36





GUTEX Thermosafe-wd

PRODUCT INFORMATION

Areas of use

- Insulation under screeds and floor coverings
- On-roof and between-rafter insulation
- Interior insulation of ceiling, wall, floor, or roof
- Insulation of timber frame and timber panel construction
- Insulation of the top floor ceiling

Advantages

- Outstanding thermal insulation
- Outstanding heat storage capacity → protection from heat in summer and cold in winter
- Improvement of sound insulation
- Moisture-regulating and steam vapour-permeable
- Able to withstand pressure
- Wood as the sustainable raw material → recyclable
- Manufactured in the direct vicinity of Switzerland (Waldshut, Black Forest)
- Ecologically safe (natureplus® certified)

Installation instructions

- Store and work with the boards in a dry place
- Use a staggered pattern with several layers
- Avoid cross joints
- The following are some of the tools that may be used to produce the cut:
 - GUTEX cutting blade for jigsaws
 - Festool sword saws
 - Mafell DSS 300 cc
 - Band or circular saws with extraction unit
- Note the legal requirements for handling wood dust
- Create a dry, level, and technically perfect substrate
- Protect from moisture
- Apply edge strips at the height of the entire structure

Maximum built-up height

Covering on GUTEX Thermosafe-wd	Maximum built-up height GUTEX Thermosafe-wd
Wet screed	140 mm
Mastic asphalt	140 mm
Chipboard ≥ 25 mm	140 mm
OSB board ≥ 22 mm	140 mm
GUTEX Thermosafe-nf	100 mm
Dry screed element ≥ 25 mm	100 mm
Prefinished engineered wood flooring ≥ 14 mm	30 mm
Laminate flooring ≥ 8 mm	20 mm



Floor structure

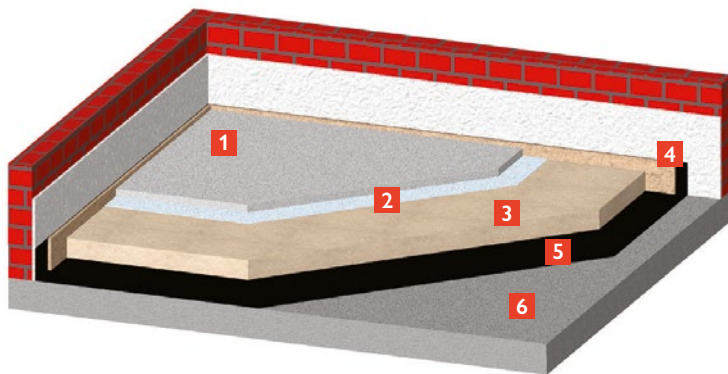

- 1 Wet screed
- 2 Moisture-protection film
- 3 GUTEX Thermosafe-wd
- 4 Edge strip
- 5 Moisture barrier as per 18195
- 6 Basement ceiling

Installation diagram

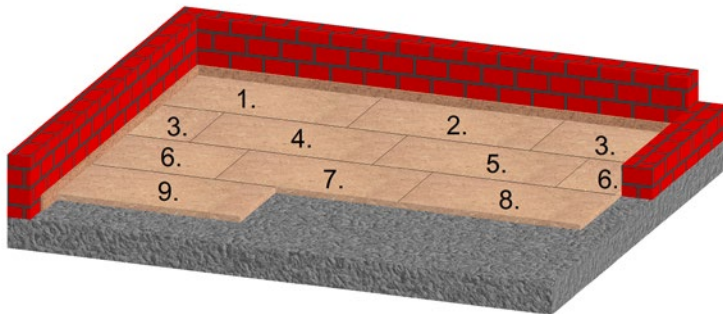

- Install GUTEX Thermosafe-wd in a bond pattern.
- The remaining piece in one installation row is placed at the beginning of the next row (see installation diagram)

